



Trussville Shopping Center

Trussville, Alabama

ARONOV

The Project

5980 Chalkville Mountain Rd
 ALDI Foods, Office Depot,
 Specialty Shops

Total Square Feet **165,641**

The Market

Total Trade
 Area Population **362,591**
 Average Household
 Income **\$76,351**

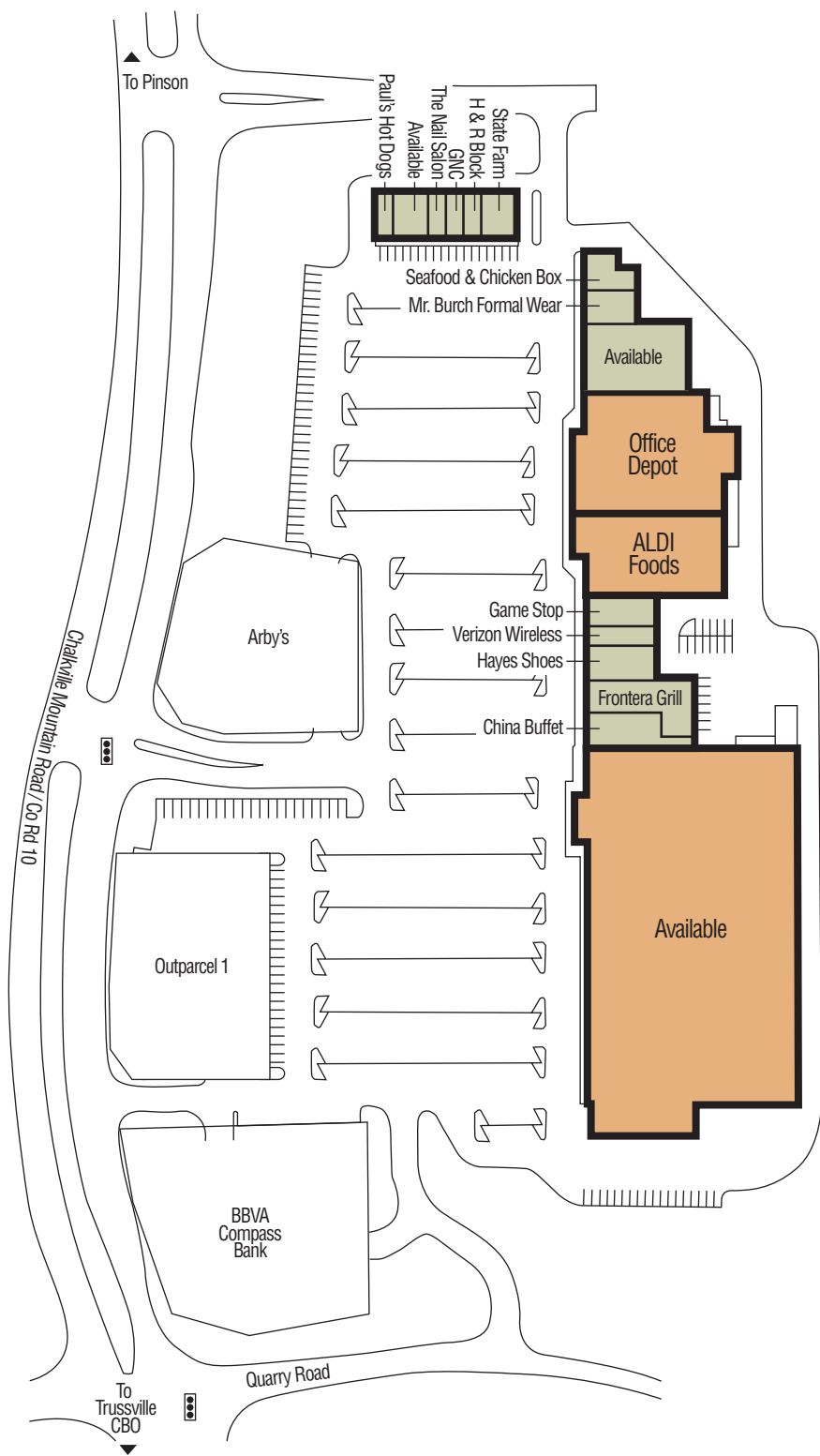

3500 Eastern Boulevard
 Montgomery, AL 36116
 www.aronov.com
 tel 334-277-1000
 fax 334-272-0747

The Center

Trussville Shopping Center

Trussville, Alabama

Location

Chalkville Mountain Road,
Trussville, Alabama

For Leasing Information
Contact Allen Schmidt
334-277-1000 ext. 425
allen.schmidt@aronov.com

- Located on Chalkville Mountain Road (County Road 10), where traffic counts exceed 32,800 vehicles per day.
- Trussville Shopping Center is centrally located in the city's growth corridor and is in close proximity to Interstate 59 and the Trussville Central Business District.
- I-59 Interchange at Chalkville Mountain Road boasts a traffic count of more than 52,160 vehicles per day.
- Adjacent to a Wal-Mart SuperCenter, Sam's Club, Kohl's and other popular retailers.
- Seafood & Chicken Box in Trussville Shopping Center was named "Where to Eat at the South's Best Fried Chicken Restaurants" by *Southern Living* Magazine.
- The center is the retail hub of northeast Birmingham which includes Irondale, Moody, Centerpoint, Clay and Huffman.

